

---

*Comfort-Cire*®

Century®

**MARS**  
Delivering Confidence

---

## PARTS LIST

# Horizontal/Side Discharge Condensing Units

CMA48SD -1

# EXPLODED VIEW

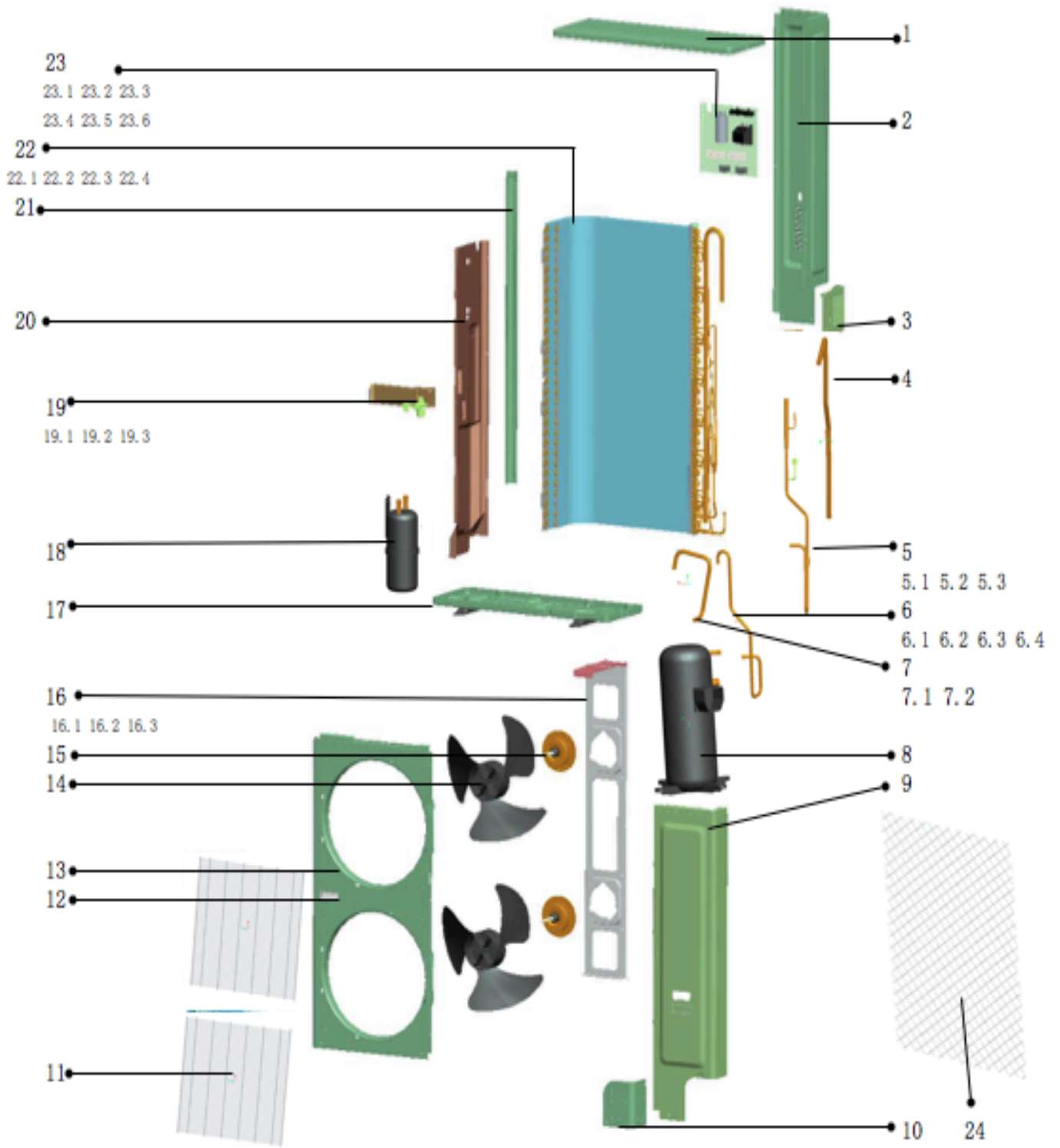

## REPLACEMENT PARTS

Location	Part Name	Part No.
1	Cover assembly with insulation	801233600118
1.1	Cover	801233600068
2	Rear clapboard	801233600063
3	Rear clapboard for valve	801233600066
4	High-pressure valve joint tube assy	801628890089
5	Discharge pipe assy	801629690055
5.1	Discharge pipe	801633490063
5.2	Discharge pipe connection assembly	801633490064
5.3	pressure swith	802300900041
6	4-Way valve assy	801633490058
6.1	4-Way valve assy	801600100030
6.2	Control wire for 4-Way valve	802401600846
6.3	connecting pipe of 4-way vavle	801633600156
6.4	connecting pipe of 4-way vavle	801633600157
6	Suction pipe	801629690054
7	Low-pressure valve joint tube assy	801629690058
8	Compressor	802428890005
9	Right clapboard	801233600175
10	Right clapboard for valve	801233600065
11	Top net	802933600003
12	Handle	801119900037
13	Front panel	801233600062
14	Propeller fan	801133600003
15	Asynchronous motor	802400400505
16	Holder for fan motor	801229690020
16.1	Holder for fan motor	801233600188
16.2	Joint board for fan motor support	801233600156
16.3	Fix and inhance rail	801233600124
17	Chassis welding parts	801233600160
18	Vapor-liquid seperator	801633600104
19.1	Valve holder	801233600076
19.2	Cut-off valve DN8	801633600130
19.3	Cut-off valve DN16	801629200002
20	Separating board	801233600183
21	Column	801233600067
22	Condenser assy	801528890021
22.1	Condenser	801528890023
22.2	Condenser	801528890026
22.3	Joint board	801233490061
22.4	Condensor collecting pipe assy	801633490071
22.5	Cunrrent divider assy for condenser	801633490067
23	E-parts components	803328890025
23.1	Instalation board for E-parts	801233690002
23.2	AC contactor	802300100251
23.3	Fan motor capacitor	802401100002
23.4	Compressor capacitor	802401000046
23.5	Gas discharge temperature sensor	802301000009
23.6	Terminal	802401800085
24	Plastic rear net	801133600002
Not Shown	Refrigerant R410a	800500100004
Not Shown	Instalation board for E-parts	801233690002
Not Shown	Compressor capacitor	802401000046
Not Shown	Fan motor capacitor	802401100002

---

Due to ongoing product improvements, specifications and dimensions are subject to change and correction without notice or incurring obligations. Determining the application and suitability for use of any product is the responsibility of the installer. Additionally, the installer is responsible for verifying dimensional data on the actual product prior to beginning any installation preparations.

Incentive and rebate programs have precise requirements as to product performance and certification. All products meet applicable regulations in effect on date of manufacture; however, certifications are not necessarily granted for the life of a product. Therefore, it is the responsibility of the applicant to determine whether a specific model qualifies for these incentive/rebate programs.

*Comfort-Aire*®

1900 Wellworth Ave., Jackson, MI 49203 • Ph. 517-787-2100 • [www.marsdelivers.com](http://www.marsdelivers.com)

